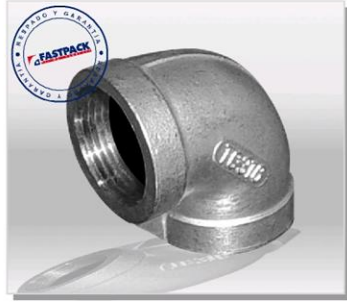
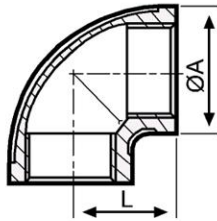
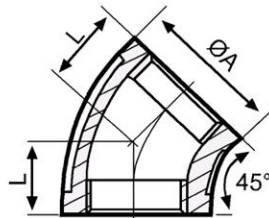
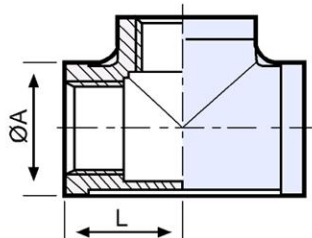

Codo 90°, Codo 45°, Tee, Cap Redonda y Plug Tapa Tornillos INOX

Codo 90° - hilo NPT, F/F - A351, 316L

SIZE	ØA	L
1/4"	21.3	21.0
3/8"	23.5	21.3
1/2"	29.0	27.0
3/4"	35.0	33.0
1"	43.0	38.0
1-1/2"	58.0	50.0
2"	71.0	58.0

Codo 45° - hilo NPT, F/F - A351, 316L

SIZE	ØA	L
1/4"	21.0	18.0
3/8"	25.0	20.0
1/2"	29.5	22.0
3/4"	35.6	25.0
1"	43.0	28.0
1-1/2"	58.0	36.0
2"	72.0	43.0

Tee - hilo NPT, F/F/F - A351, 316L

SIZE	ØA	L
3/8"	23.5	23.6
1/2"	29.0	27.0
3/4"	35.0	33.0
1"	43.0	38.0
1-1/2"	58.0	50.0
2"	71.0	58.0

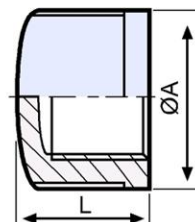
Cap Redonda - hilo NPT, F - A351, 316L

SIZE	ØA	L
3/8"	24.0	17.0
1/2"	27.3	19.0
3/4"	35.0	24.0
1"	42.0	29.0
1-1/2"	57.5	34.0
2"	69.3	38.0

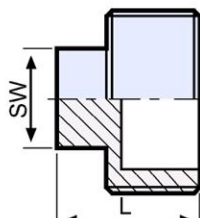
Plug, Tapa Tornillos - hilo NPT, M - A351, 316L

SIZE	L	SW
3/8"	22.0	11x11
1/2"	25.0	13x13
3/4"	27.0	16x16
1-1/2"	37.0	25x25
2"	38.0	32x32